

Checking the cylinder packings:

- Check the cylinder packings with the dial gauge.
- **Blanket cylinder:** blanket with underpacking = **0.03 to 0.05 mm** above bearer.
- **Plate cylinder:** plate with underpacking = **0.1 mm** above bearer.

Cylinder packings

Plate cylinder
with standard clamps

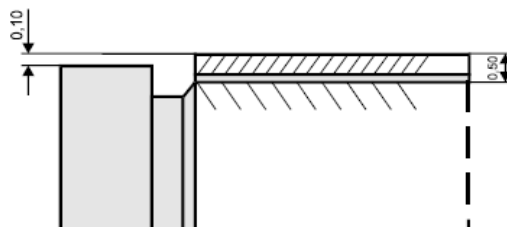

Blanket cylinder

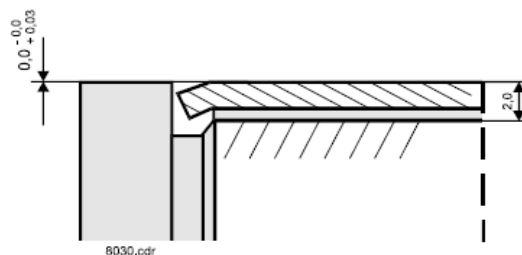

Note: To compensate for print length differences, the packing on the plate cylinder in printing unit 1 is increased by 0.01 to 0.02 mm (0.11 to 0.12 mm above bearer).

Presses with the CPL

	R302			R304			R305			R306			R307			R308		
	AD	GF	DF	AD	GF	DF	AD	GF	DF	AD	GF	DF	AD	GF	DF	AD	GF	DF
M1	0,25	0,11	0,14	0,25	0,11	0,14	0,25	0,11	0,14	0,26	0,10	0,16	0,26	0,10	0,16	0,26	0,10	0,16
M2	0,24	0,10	0,14	0,24	0,10	0,14	0,24	0,10	0,14	0,25	0,11	0,14	0,25	0,11	0,14	0,25	0,11	0,14
M3				0,24	0,10	0,14	0,24	0,10	0,14	0,24	0,10	0,14	0,25	0,11	0,14	0,25	0,11	0,14
M4				0,24	0,10	0,14	0,24	0,10	0,14	0,24	0,10	0,14	0,25	0,11	0,14	0,25	0,11	0,14
M5							0,24	0,10	0,14	0,24	0,10	0,14	0,24	0,10	0,14	0,25	0,11	0,14
M6										0,24	0,10	0,14	0,24	0,10	0,14	0,24	0,10	0,14
M7													0,24	0,10	0,14	0,24	0,10	0,14
M8																0,24	0,10	0,14

AD = Packing without printing plate

GF = Base foil

DF = Cover foil

Recommendation: The thickness of the foils given in the table are for guidance only (provided with the press).
The correct printing length should be determined by a print test (grid forme).
Use other foils depending on print test results.

Note: When impression is ON, the press always runs in bearer contact. This setting cannot be changed! (by the operator).