

Versant 180/3100 Fiery Small Fonts Recommended Settings

Recommendations and resulting print examples.

1. Set Text/Graphics Sharpness to None (to counter disappearing image along text curves. This is especially true for thin stroke areas of text.)
2. Uncheck Color/Text Graphics Enhancement (to counter possibly increasing starvation effects around text with a background, as well as, faint text when it's half-toned thin stroke text against a white background)
3. Set Trapping and Turn it on in Job Properties (to counter the background fuzziness text against a background)
- a. Set trapping to ~50 % for CMY and K (the trap doesn't need to be very strong, just enough to help counter some of the starvation)

DFE Setting

- As our recommendation, 1.Resolution, 2.Graphics and Text half tone mode, 3.Text/Graphics quality, 4.Color text/graphics enhancement, 5.Text/graphics sharpness and 6.Trapping are changed from default.

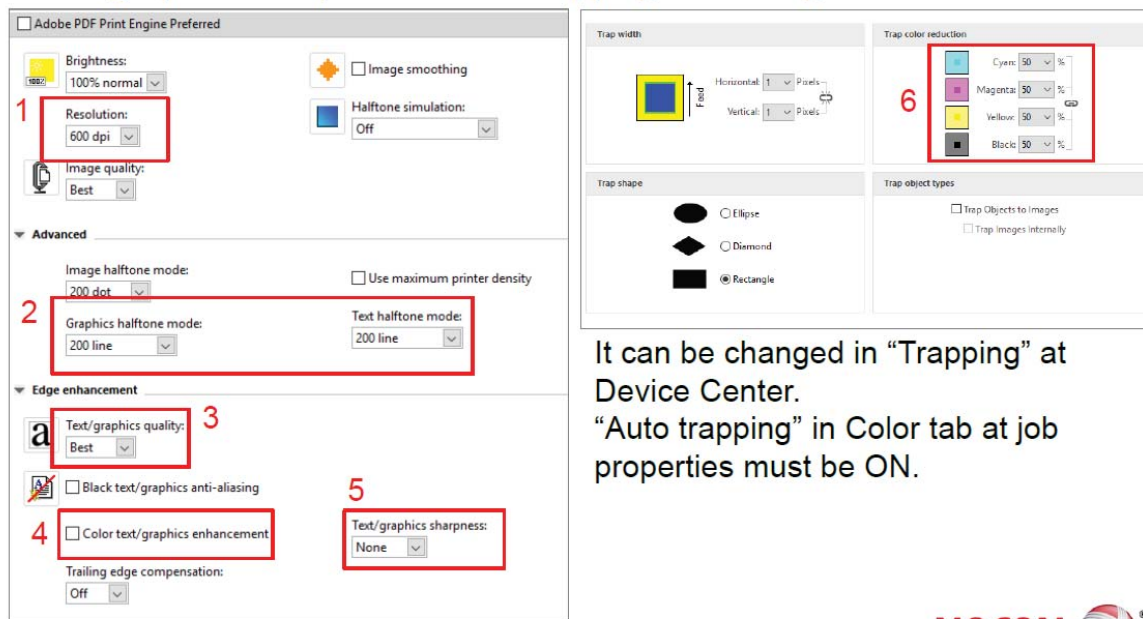

It can be changed in "Trapping" at Device Center.

"Auto trapping" in Color tab at job properties must be ON.

Result

- Low Resolution and Line screen make the text darker.
- Color text/graphics enhancement and 5. Text/graphics sharpness OFF make the small text stronger.
- Trapping compensate the drop off text in the orange circle.

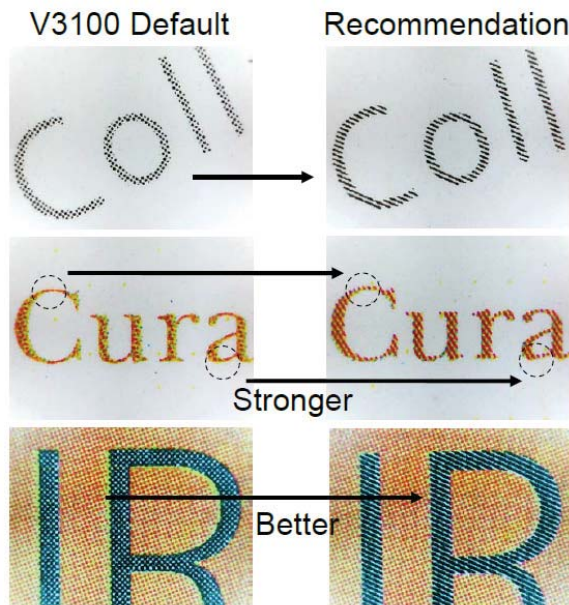

Text gets darker.

Thin text gets stronger.

Text pops up more clearly.

Descriptions:

Text/Graphics Quality:

This is fairly typical smoothing out of the text curves when text is not 100 % black.

Text/Graphics Sharpness:

Half-toned text is refined on the edges by taking out pixels along the edges. It, however, has no threshold based on width of text stroke or graphic width. Thin stroke text and small text can end up losing pixels it cannot afford to, making certain areas look unresolved and in some cases noisy or mottled. The circled areas on the 2nd row of pics on the Results slide of the pdf.

Color Text/Graphics Enhancement:

This works only on non 100 % K text. In the 3rd row of the slide, you should be able to see a thin black line border. The strength of the thin line causes a slight repelling effect, (i.e. starvation). Strategic trapping helps to offsets some of this. It is best to leave it unchecked when text runs across non-paper background.

'Brightness' feature can be used as an additional supplement to increase darkness/density of the halftone black text if required, when a subtle low percentage setting is used ie: 105 %, it will not impact on any other objects such as images or graphics to any significant negative degree in many cases.

EFI official video link that explains the Fiery colour ticket settings...

<https://www.youtube.com/watch?v=QJQmERqCqAQ>

(This video does not include the edge enhancement ticket features now seen in recommendations)